

Description

Anodized aluminum neoprene construction joint for use with tiles and stone. Installed when floor finish is being laid.

Materials:

Bases: Anodized aluminium 6063/T6
(Stainless Steel or Brass available upon request).
Santoprene or Neoprene joint strip. (EPDM)

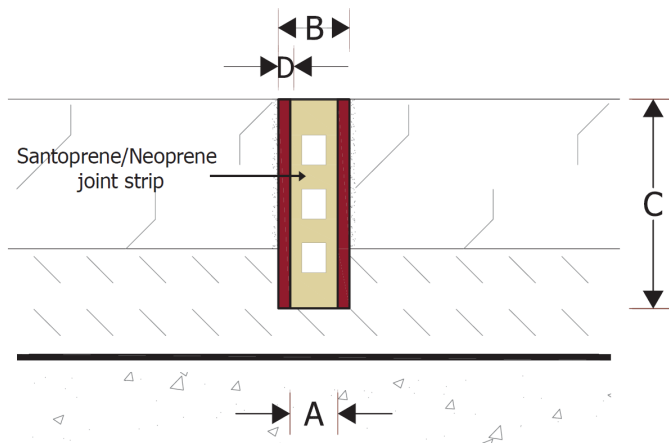

Joint Strip Colour



Black



Beige



Grey

(Other colors available subject to 500m minimum order)

TYPE	A	B	C	D	Total Movement
CJ1 14/5	5	9	14	2	±2
CJ1 14/8	8	12	14	2	±2
CJ1 20/5	5	9	20	2	±2
CJ1 20/8	8	12	20	2	±2
CJ1 30/8	8	12	30	2	±2
CJ1 40/8	8	12	40	2	±2
CJ1 50/8	8	12	50	2	±2
CJ1 50/10	10	14	50	2	±2
CJ1 75/8	8	12	75	2	±2
CJ1 80/10	10	14	80	2	±2

Custom sizes can be produced upon request

Dimension in mm