



Description

Anodized aluminum construction joint for use with tiles and stone. Installed beneath the screed

Materials:

Bases: Anodized aluminium 6063/T6
Santoprene & Neoprene joint strip (EPDM)

Joint Strip Colour



Black



Beige



Grey

(Other colors available subject to 500m minimum order)

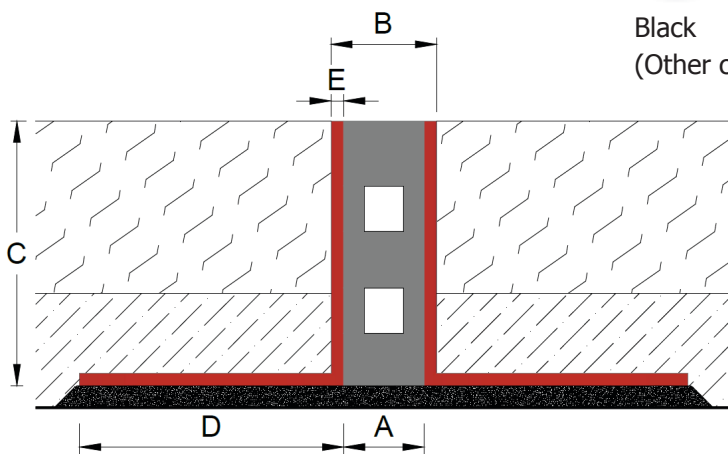

TYPE	A	B	C	D (AL Series)	D (SS/BR Series)	E (AL Series)	Total Movement
CJ2-SS 15/10	6.9	10	15	20	15	1.8	-4+2
CJ2-SS 20/10	6.9	10	20	15	20	1.8	-4+2
CJ2-SS 25/10	7.5	10	25	25	20	1.5	-4+2
CJ2-SS 30/10	7.3	10	30	15	20	1.6	-4+2
CJ2-SS 50/10	6.5	10	50	50	25	2	-4+2
CJ2-SS 75/10	5.9	10	75	50	30	2.3	-4+2
CJ2-SS 15/12	8.9	12	15	20	15	1.8	-4+2
CJ2-SS 20/12	8.9	12	20	15	20	1.8	-4+2
CJ2-SS 25/12	9.5	12	25	25	20	1.5	-4+2
CJ2-SS 30/12	9.3	12	30	15	20	1.6	-4+2
CJ2-SS 50/12	10.5	12	50	50	25	2	-4+2
CJ2-SS 75/12	7.9	12	75	50	30	2.3	-4+2
CJ2-SS 15/15	11.9	15	15	20	15	1.8	-4+2
CJ2-SS 20/15	11.9	15	20	15	20	1.8	-4+2
CJ2-SS 25/15	12.5	15	25	25	20	1.5	-4+2
CJ2-SS 30/15	12.3	15	30	15	20	1.6	-4+2
CJ2-SS 50/15	11.5	15	50	50	25	2	-4+2
CJ2-SS 75/15	10.9	15	75	50	30	2.3	-4+2

Custom sizes can be produced upon request

Dimension in mm